



# Model: ECHO-4

LCD 2-way Upgrade Kit



November 21, 2012

## Operation & Installation Guide

## Table Of Contents

Installing & Programming The ECHO System.....	3
Controller Overview .....	4
The 2-Way Controller .....	4
System Operations.....	4
LCD Screen Icons .....	5
In-Range Indicator.....	5
Screen Illumination.....	5
Multi-Car Operation .....	6
Selecting CAR #1 or CAR #2 .....	6
Controller Options.....	6
Parking Timer & Remote Start Timer.....	6
Selecting Melody & Vibrate Modes.....	6
Setting The Clock .....	7
Changing Remote Start Melodies .....	7
Button Lock .....	7

## Installing & Programming The ECHO System

The ECHO-4 communicates with a window-mounted base unit which is plugged directly into the host system's module. The window-mount antenna should be mounted directly to the interior glass by utilizing the attached adhesive pad (clean the glass before adhering) for the best performance. The receiver/transmitter also contains alternative Status Lights and a Valet Switch. these may be used, or the original items may be retained.

**NOTE: You must install the controller batteries before use.**

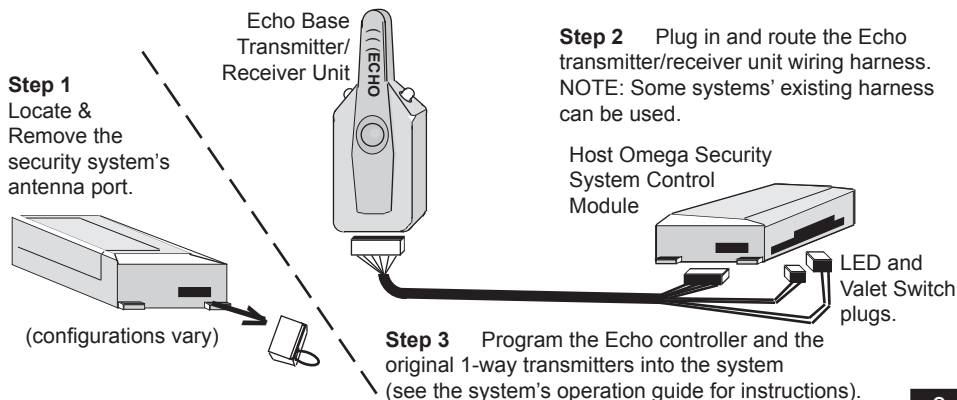

## Controller Overview

### THE 2-WAY CONTROLLER

Controller part number: 154-03

1) **LCD Display:** Displays all controller functions as well as the status of your system.

2) **Control Buttons:** Lock, Unlock, Trunk Release, Remote Start / 3rd Channel

3) **Programming Button:** This configures the controller's features.

#### **Transmitter battery replacement:**

Remove the door from the back case, and replace the two **CR2032** batteries. Then replace the door securely.



### SYSTEM OPERATIONS

Your system operations are dependant on the design of the system being used with the ECHO kit. Please refer to the system's operation guide for details on each function. The controller buttons will perform the same operations as your original transmitter's buttons

## Controller Overview (cont'd)

### LCD SCREEN ICONS

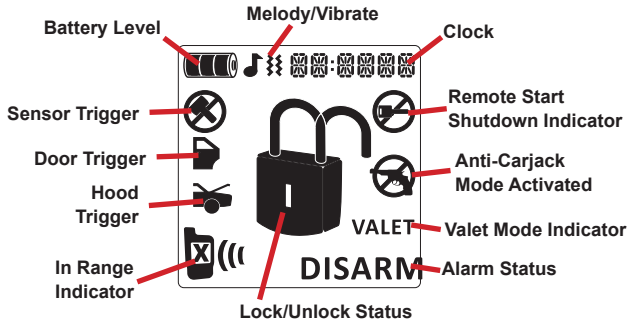

### IN-RANGE INDICATOR

All primary commands sent to the system have a confirmation response that is sent to the controller to indicate that the command was successful. If the command is successful, the icon will not display the "X" in the middle of the icon. If no response is received within a few seconds, the "X" will be displayed indicating that you may be out of range of your system.

### SCREEN ILLUMINATION

The LCD screen can be illuminated in dark environments by momentarily pressing the "P" button. The screen will illuminate for 5 seconds with each press.

## Multi-Car Operation

When controlling 2 systems, the controller will receive all status updates on the currently selected vehicle and will receive only trigger alerts for the 2nd vehicle. Use these steps to change vehicles:

### **SELECTING CAR #1 OR CAR #2**

**Vehicle #1:** Press the “P” and “LOCK” buttons for 1 second to select Car #1. The controller will beep/vibrate once and the clock will change to “CAR 1”.

**Vehicle #2:** Press the “P” and “UNLOCK” buttons for 1 second to select Car #2. The controller will beep/vibrate twice and the clock will change to “CAR 2”.

## Controller Options

### **PARKING TIMER & REMOTE START TIMER**

The controller has 2 convenient timer functions. The PARKING TIMER tells you how long you've been parked in case you are at a parking meter or other parking areas with time restrictions. The REMOTE START TIMER tells you how long your engine has been running in remote start mode.

**PARKING TIMER:** Press LOCK twice within 5 seconds. When the controller receives both LOCK confirmations, it will start the timer indication by the clock changing to “00:00 P”.

**REMOTE START TIMER:** This turns on every time you remote start. indicated by the clock changing to “00:00RS”.

**Note:** Pressing the “P” during either timer mode will switch between the timer and clock.

### **SELECTING MELODY & VIBRATE MODES**

Whenever 2-way alerts are received from the system, the controller can alert you with a melody, vibration, or both. By default, the controller is set for melody only. **Press the “P” and “TRUNK” buttons simultaneously for 1 second to change the setting.** The melody & vibrate icons on the status screen will turn on & off indicating your selection.

### **SETTING THE CLOCK**

- 1) Press the "P" button for 5 seconds to access the controller features. The controller will beep twice.
- 2) Press and release the "P" button once to select the clock (hour digits will flash).
- 3) Press the "TRUNK" button to scroll up or the "\*" button to scroll down.
- 4) Press the "P" button to switch to the minute digits.
- 5) Press the "TRUNK" button to scroll up or the "\*" button to scroll down.
- 6) Wait 10 seconds or press the "P" button to exit programming. The controller will beep once.

### **CHANGING REMOTE START MELODIES**

The controller has 5 different melodies to choose from for remote start ON and 5 melodies for remote start OFF confirmation.

- 1) Press the "P" button for 5 seconds to access the controller features. The controller will beep twice.
- 2) Press and release the "P" button 3 times to select the melody settings. The clock will change to "01 STRT" indicating "start melody #1" for the remote start ON melody.
- 3) Press the "TRUNK" button or the "\*" button to scroll through the melodies.
- 4) Press the "P" button to switch to the remote start OFF melody selection.
- 5) Press the TRUNK button or the "\*" button to scroll through the melodies.
- 6) Wait 10 seconds or press the "P" button to exit programming. The controller will beep once.

### **BUTTON LOCK**

You can lock the buttons on the controller to prevent accidental button presses. To lock the buttons, press "P" and "\*" simultaneously for 1 second. Repeat this to unlock the buttons.

This device complies with FCC Rules part 15. Operation is subject to the following two conditions, (1) This device may not cause harmful interference and, (2) This device must accept any interference that may be received, including interference that may cause undesired operation.

The manufacturer is not responsible for any radio or TV interference caused by unauthorized modifications to this equipment. Such modifications could void the user's authority to operate the equipment.



[www.caralarm.com](http://www.caralarm.com) | 800.554.4053



[www.facebook.com/omegard](https://www.facebook.com/omegard)