

Crime Guard

Keyless Entry and Security®

OPERATION MANUAL

745i²

Table Of Contents

Introduction	3
Remote Control Auditing System	4
System Armed & Activated	5
Last Door Arming & Rearming	6-7
Remote Control Operation	8-13
Arming By-Pass	8
Intrusion Alert	8
Remote Arming & Disarming	9
Silent Arming & Disarming	9
Disarm W/ Driver's Door Unlock	10
2nd & 3rd Vehicle Operation	11
Remote Panic	11
Auxiliary Channels #1 & #2	12
Remote Anti Car-Jacking Activation	12
Remote Sensor By-Pass	13
Remote Temporary Valet	13
Anti Car-Jacking Protection	14
Red LED Status Indicator	15
Using The Easy Valet Switch	16-17
Valet Mode	16
Emergency Override	17
Impact Sensor & Prewarn Detection Circuit	18
Back-Up Battery	19
Explanation Of Programmable Features	20-22
Programming The 328i	23-26
Remote Control Quick Reference Guide	27-29

INTRODUCTION:

Congratulations on your purchase of a new Crime Guard security system. In learning how to operate your security system, please become familiar with the following three principal components: the Remote Control, the Red LED Status Indicator and the Easy Valet Switch.

The Remote Control: Each security system comes with two pre-learned remote controls, but can learn up to 4 different remote controls. Every remote control has its own unique, invisible code. Thus, no other remote is coded the same as yours. In fact, no one, including the factory, can program another remote exactly like yours because the code is encrypted inside the remote's master microprocessor and cannot be seen or duplicated. The remote has three buttons: A large button and two smaller buttons. Please refer to pages #8-13 for operating instructions.

Easy Valet Switch: The Easy Valet switch has three main functions:

1. The Easy Valet switch can be used to turn "Off" the security portion of the system, including the programmable Automatic Last Door Arming feature, thus entering the system into the Valet mode.
2. The Easy Valet Switch can also be used in conjunction with the vehicle's ignition key switch to perform an emergency Disarm of the security system in the event the remote control is lost or becomes inoperable.
3. The Easy Valet switch is used in the programming mode.

The Red LED Status Indicator Light: The 11-function LED indicates the status of the security system and serves as a visual deterrent to break-ins and theft. Refer to pages #15. The LED is also part of the patented Remote Auditing System technology, which is explained in detail on page #4, and of the system alarm activation recall memory.

Please spend time reviewing this guide to become familiar with your Crime Guard vehicle security system. You will find that your new Crime Guard vehicle security system will give you years of trouble-free convenience and protection.

REMOTE CONTROL AUDITING SYSTEM™ (RCAS)

The patented remote Control Auditing System™ technology, which is standard on all Crime Guard vehicle security systems, is the industry's only response to a growing problem. In a matter of seconds, any knowledgeable person familiar with programming remote controls to vehicle security systems can code an unauthorized remote to operate the security system. Although every vehicle security system operated by a radio transmitter is susceptible, Crime Guard security systems audibly alerts you if the system's programming mode has been accessed and visually informs you of the number of remote controls capable of operating your system.

How It Works:

Audible RCAS: Anytime the system's programming mode is accessed or its main power is disconnected, the siren will emit a series of chirps every time the vehicle is started for 48 hours. This audible warning alerts you to the possibility that the system may have been tampered with. You can then refer to the red LED status indicator to confirm how many remote controls are programmed to operate the system. The audible RCAS will be active for the first 48 after the system is installed.

Visual RCAS: For a period of 10 seconds after the vehicle's ignition is turned "On", or 90 seconds if the audible RCAS has been activated, the LED Status Indicator will flash a number of times equal to the number of remote controls which are programmed to operate the security system.

- 1 Flash /pause = 1 remote control is programmed.
- 2 Flashes /pause = 2 remote controls are programmed.
- 3 Flashes /pause = 3 remote controls are programmed.
- 4 Flashes /pause = 4 remote controls are programmed.

For example: After turning "On" the vehicle's ignition, if the LED flashes twice and pauses only 2 remote controls are programmed to operate the system. In the event that the LED Status Indicator flashes a number different from the number of remote controls you have programmed to operate the system, you can easily erase all remotes programmed in the system's memory and immediately reprogram your remotes; thereby, eliminating any unauthorized remote control(s) from the system's memory. (Refer to pg #23-24)

SYSTEM ARMED & ACTIVATED:

There are two methods of Arming the security system:

1. The first method is the push of a remote control to "Actively" arm the system, provided the vehicle's ignition switch is "off" and the security system is Disarmed but not in Valet Mode (pg #9).
2. The second method is a programmable feature called "Last Door Arming" which allows the system to Automatically or Passively Arm (pg #6).

When the system enters the Armed state:

- The siren will chirp twice. (No chirps if Silently Armed)
 - The siren will chirp four times if a zone is by-passed upon arming. (Pg #8)
 - The parking-lights will flash twice. (Four times if a zone is by-passed)
 - The doors will lock. (If Installed)
 - The starter interrupt will engage.
 - The LED status indicator will begin flashing slowly to confirm that the system is armed.
- Three seconds after the siren chirps, the security system will be fully armed state and will trigger instantly if an intrusion attempt is detected.

An alarm condition consists of the following:

1. The electronic siren will sound, changing its sound every 5 seconds.
2. The exterior parking-lights will flash.
3. The doors will re-lock. This feature is unique to Crime Guard security systems. The system knows when a door is opened and, if so, waits until the door(s) is closed before relocking it, so that the thief cannot easily regain entry.

An alarm condition has a 30 or 60-second duration unless the system is disarmed using one of your remote controls or the Easy Valet switch. If all protected zones are secure at the end of the alarm condition, the system will stop and rearm automatically ready to detect another entry attempt. If a protected zone is still open at the end of the alarm condition, the system will reactivate for up to 2 additional alarm cycles. After the third alarm cycle the system will automatically rearm and bypass the open zone until that zone is closed.

LAST DOOR ARMING & REARMING:

Automatic Last Door Arming: Automatic “Last Door Arming” is a programmable feature which allows the system to Arm itself. If On, this convenient feature offers a high level of security and may entitle the vehicle owner to an insurance discount since the user does not need to remember to Arm the system each time the vehicle is exited. The “Last Door Arming” feature may be coupled with the Passive Door Locking feature, in which case the system would automatically lock the vehicle’s doors when it self Arms.

Last Door Arming Process:

1. When the vehicle’s ignition has been turned “Off” and the last door is closed the siren will emit a double chirp, the parking lights will flash twice, and the LED indicator will begin flashing rapidly to confirm that the last door arming countdown has begun.
2. 30 seconds later the system will automatically Arm. Upon Arming, the siren will again emit a double chirp, the parking lights will again flash twice, the vehicle’s doors will lock (If installed & programed), the starter interrupt will engage, and the LED will begin flashing slowly to confirm that the system is fully Armed.

Notes:

- Passive “Last Door Arming” does not effect the operation of active arming using the remote control.
- All protected points must be closed for the Automatic “Last Door Arming” sequence to start. The system can not by-pass an open or defective zone and self-arm while a protected point is open. If, for example, a vehicle door is reopened during the 30-second arming countdown, the countdown will stop and reset, starting over when the last door is closed again.
- The system can only by-pass an open or defective zone when actively Armed using a remote control.

To prevent the system from self Arming during fueling the user can:

1. Place the system in Valet Mode using the Easy Valet switch. (Pg #16)
2. Maintain a vehicle door open.
3. Turn “On” the dome light switch so that the system thinks a door is open. Leaving the ignition key turned "On" is not recommended.

Automatic Rearm: If this programmable feature is selected, the system will automatically initiate a 90-second Rearm countdown every time the system is Disarmed using a remote control. If no protected entry points are opened and the vehicle's ignition is Not turned "On", the system will Rearm automatically at the end of the countdown. If the "Door Lock With Automatic Rearm" feature is selected, the vehicle's doors will lock upon Rearm.

-All protected points must be closed for the Automatic Rearm sequence to begin. The system can not by-pass an open or defective zone and Rearm while a protected point is open. If, for example, a vehicle door is opened during the 90-second Rearming countdown, the countdown will stop and reset, starting over when the last door is closed again.

-Turning the vehicle's ignition "On" will cancel the automatic Rearming process.

Note: The Automatic Rearming sequence is confirmed by a fast flashing LED Status Indicator after Disarming the system, unless the security system has been triggered & reset, in which case a Zone Violation code will flash instead. (Refer to pg #15)

REMOTE CONTROL OPERATION:

The system may be Armed anytime using a remote control provided the vehicle's ignition switch is "off" and the security system is Disarmed but Not in Valet Mode. The remote control is also capable of operating a variety of functions which are explained in the following pages.

Arming By-Pass: Upon arming using a remote control, if any protected zone or sensor circuit is open or inoperable, that circuit will be automatically bypassed until 5 seconds after that circuit is closed or becomes operative. Only the particular zone will be by-passed, all other zones remain completely operational & vigilant.

The siren will emit 4 chirps and the parking lights will flash four times if the hood, trunk, or sensor zone is by-passed when the system is remotely Armed in order to alert you. The siren & lights will Not confirm if a door zone is by-passed. This is due to the fact that so many vehicles come equipped with an interior dome light illumination delay which would cause the system to confirm by-pass every time the system is Armed using a remote control. In these cases the door zone would come on-line 5 seconds after the interior dome light turns Off.

For example: If the trunk is left open, the system can still be actively Armed using the remote control. The bypassed circuit will automatically be reinstated for protection 5 seconds after the trunk is closed.

Intrusion Alert: If the system enters an alarm condition while Armed, upon Disarming the siren will emit three chirps and the parking lights will flash three times before illuminating for 30 seconds (If programmed) to alert the user.

The Red LED Indicator Light will stop flashing slowly and begin to flash & pause to indicate which protected zone was violated, causing the alarm condition, until the vehicle's ignition is turned "On". The system's alarm condition recall memory circuit can store up to 2 consecutive zone violations. If there have been multiple zone violations, the LED will replay the two most recent in the order in which they occurred. (pg #15)

Note: Turning "On" the vehicle's ignition clears the alarm recall memory.

REMOTE ARMING & DISARMING:

To Arm/Disarm The System:

Press & Release The Large Button

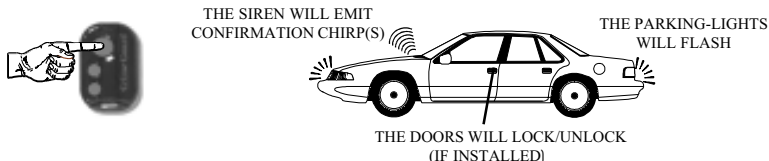

To Silently Arm/Disarm The System:

First Press & Release The Lower Small Button, Then Press & Release The Large Button.

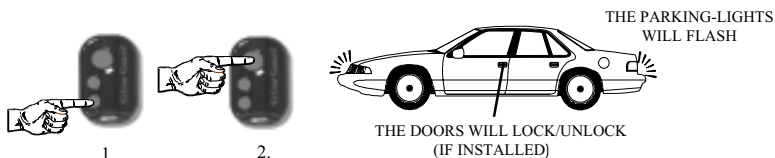

Upon Arming:

- The siren will chirp twice. / No chirps if Silently Armed.
 - The siren will chirp four times if a zone is by-passed upon arming. (Pg #8)
- The parking-lights will flash twice. / Four times if a zone is by-passed.
- The doors will lock. (If installed)
- The starter interrupt will engage.
- The LED status indicator will begin to flash slowly.

Upon Disarming:

- The siren will chirp once. / No chirps if Silently Disarmed.
- The parking-lights will flash once, then if programmed, illuminate for 30 seconds or until the vehicle's ignition is turned "On".
- The dome-light will illuminate for 30 seconds or until the vehicle's ignition is turned "On". (Dome-light illumination optional)
- All doors will unlock. (If installed)
- The starter interrupt will disengage.
- The LED will flash or turn "Off" depending on features & conditions:
 - Flashing rapidly = Last Door Arming or Rearm feature is in progress.
 - LED Off = Last Door Arming and/or Rearm features Not selected.
 - Flash /Pause = Indicates violated zone if system has been activated.

DISARM WITH DRIVER'S DOOR UNLOCK (Requires special installation)...

To Disarm The System & Unlock The Driver's Door:

NORMAL DISARM: Press & Release the large button.

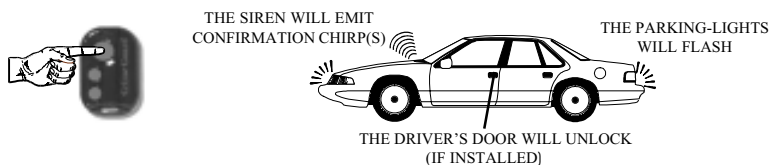

SILENT DISARM: First Press & Release The Lower Small Button, Then Press & Release The Large Button.

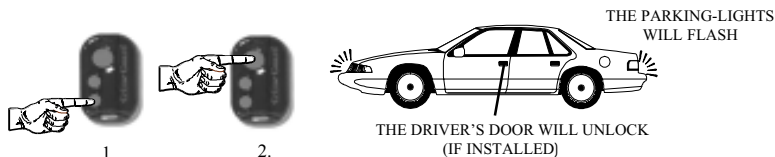

To Unlock The Rest Of The Vehicle's Doors:
Within 3 seconds of Disarming the system, Press & Release the large button.

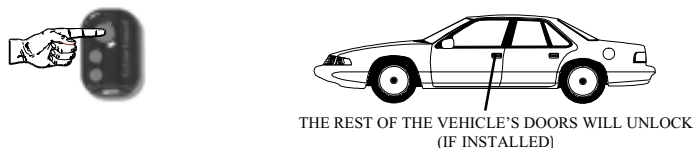

2nd & 3rd VEHICLE OPERATION:

Up to three systems may be independently operated using a single remote control. The remote's button functions are different for each vehicle. This prevents Arming & Disarming the multiple systems simultaneously. (Refer to the following chart for button function assignment)

<u>Arm/Disarm</u>	<u>Aux Channel #1</u>	<u>Aux Channel #2</u>
Large Button	Upper Small Button	Lower Small Button
Upper Small Button	Large Button	Lower Small Button
Lower Small Button	Large Button	Upper Small Button

REMOTE PANIC:

To Activate Panic:

Press & Hold The Large Button for 3 Seconds.

To Deactivate Panic:

Press & Release The Large Button.



THE SIREN SOUNDS

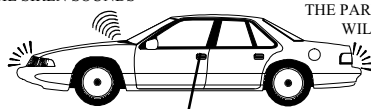

THE PARKING-LIGHTS
WILL FLASH

THE DOORS WILL UNLOCK
(IF INSTALLED)

Upon Activating Panic:

- The electronic siren will sound.
 - The vehicle's exterior parking-lights will flash.
 - The vehicle's doors will unlock. (If installed)
- The Panic cycle is designed for situations in which the user feels threatened and/or a need to attract attention. Panic can be activated anytime, whether the vehicle's ignition is turned "On" or "Off", and has a 30/60-second duration unless it is deactivated using a remote control. At the end of the Panic cycle the system will reset, enter the Armed state, and lock the doors (If installed).

AUXILARY CHANNEL #1:

To Activate The Auxiliary Channel:

Press & Hold The Upper Small Button For 3 Seconds.

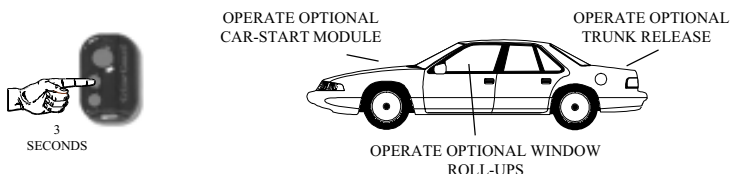

Auxiliary output #1 may be used to operate a variety of options and can be programmed to Disarm the security system upon it's activation.

-The auxiliary channel may be activated anytime the vehicle's ignition key is "Off" and system is Disarmed, or in Valet. The auxiliary channel may also be activated while the vehicle's ignition key is in the "On" position as long as a vehicle door is open. This prevents the auxiliary channel from being accidentally activated while driving.

AUXILARY CHANNEL #2

To Activate Auxiliary Channel #2:

Press & Hold The Lower Small Button For 3 Seconds.



REMOTE ANTI CAR-JACKING ACTIVATION

To Remotely Activate Anti Car-Jacking Protection:

With the vehicle's ignition "On", Press & Hold The Lower Small Button For 3 Seconds.



-The remote anti car-jacking feature must be programmed. (pg #14)

REMOTE SENSOR BY-PASS:

To Activate Remote Sensor By-Pass:

First Arm The System, Then Within 4 Seconds Press & Release The Lower Small Button.

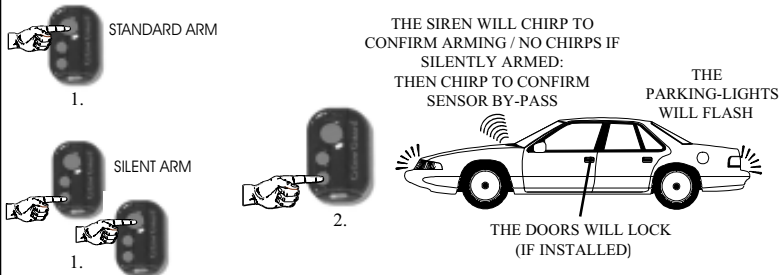

Remote Sensor By-Pass allows the option of “turning Off” the sensor any time the system is Armed using a remote control. Anytime the sensor is remotely bypassed, only the sensor zone is by-passed, all other protected zones will remain fully operational and vigilant. The sensor zone will reset to its normal operation the next time the system Arms.

REMOTE TEMPORARY VALET:

To Activate Remote Temporary Valet:

First Disarm The System, Then Within 4 Seconds Press & Release The Lower Small Button.

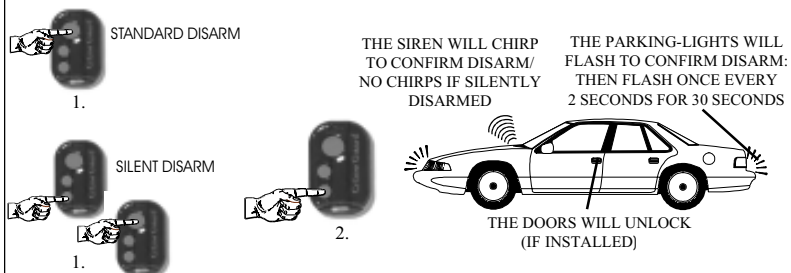

Remote Temporary Valet allows the user to stop the system from automatically Rearming. The system will remain in Temporary Valet until either the system is Armed using a remote control, a vehicle door is opened & closed, or the ignition is turned “On”.

ANTI CAR-JACKING PROTECTION:

Your system is equipped with a programmable tri-level Anti Car-Jacking system. The anti car-jacking system may be activated through the ignition, a combination of the ignition and an open door, or a remote control.

Level #1: Anti Car-Jacking activated through the vehicle's ignition:

If programmable feature #12 is "On", the system will initiate the Anti Car-Jacking process every time the vehicle's ignition is turned "On".

Level #2: Anti Car-Jacking activated through ignition and a door:

If programmable features #12 & 13 are "On", the system will initiate the Anti Car-Jacking process every time

-The ignition is turned "On". (Level #1)

-The ignition is "On" and a vehicle door is opened. (Level #2)

Level #3: Anti Car-Jacking activated using a remote control:

If programmable feature #14 is "On", the Anti Car-Jacking sequence may be activated using a remote control any time the ignition is "On".

To remotely activate the Anti Car-Jacking process: Press & Hold the lower Small button on the remote control for 3 seconds with the vehicle's ignition turned "On". (Refer to pg #12)

Once the Anti Car-Jacking process has begun, the user has 53 seconds to enter the programmed Override Valet Code (Refer to feature #2; pg #24) using the Easy Valet switch in order to cancel the process. If not cancelled, at 53 seconds the siren will begin to chirp for 7 seconds to alert the user that the system is about to enter into an alarm condition. If the Anti Car-Jacking process is not cancelled before the 60-second countdown expires the system will enter an alarm condition. In an alarm condition the siren will sound and the parking lights will flash. 30 seconds after the siren & lights activate, or the instant the ignition is turned "Off", the stater interrupt will engage. The system will Not respond to the remote controls and will Not reset automatically.

Once fully triggered the Anti Car-Jacking can only be disengaged by:

Step 1: Turning the vehicles's ignition "Off".

Step 2: Turning the vehicle's ignition "On".

Step 3: Entering the Override Valet Code using the Easy Valet switch.

RED LED STATUS INDICATOR:

The 11 function Red LED Status Indicator Light visually confirms the status of the system and provides a high level of visual deterrence. Additionally, the LED is also part of the patented Remote Control Auditing System and the alarm condition recall memory feature. The Red LED Status Indicator is normally mounted in a location where it can be easily seen by the driver, as well as from outside the vehicle.

Security System Status: The primary function of the Red LED Status Indicator Light is to indicate the status of the security system:

- 1) Off = The System is Disarmed and not performing automatic functions.
- 2) On Constant = The system is in the Valet Mode.
- 3) Flashing Slow = The system is fully Armed.
- 4) Flashing Fast = Last Door Arming or Rearming process is in progress.

Remote Control Auditing: For the first 10 seconds after the vehicle's Ignition is turned "On", the LED Indicator Light will flash a number of times equal to the number of remote controls which are programmed in the system's memory and can operate the system. (pg #4)

- 5) 1 Flash /pause = 1 remote control is programmed.
- 6) 2 Flashes /pause = 2 remote controls are programmed.
- 7) 3 Flashes /pause = 3 remote controls are programmed.
- 8) 4 Flashes /pause = 4 remote controls are programmed.

Alarm Condition Recall Memory: If the system enters an alarm condition, the Red LED Status Indicator Light will stop flashing slowly and begin to flash in sequence to indicate which protected zone caused the alarm condition. The LED will flash & pause to indicate which protected zone was violated while the system is still Armed, after it's Disarmed, and until the vehicle's ignition is turned "On". The system's alarm condition recall memory circuit can store 2 consecutive zone violations. If there have been multiple violations, the LED will replay the two most recent in the order in which they occurred.

Note: Turning "On" the ignition will clear the alarm recall memory.

- 9) 2 Flashes /Pause = System was triggered through the hood or trunk.
- 10) 3 Flashes /Pause = System was triggered through the door.
- 11) 4 Flashes /Pause = System was triggered by the optional sensor.

USING THE EASY VALET SWITCH:

The 3 primary functions of the Easy Valet switch are:

1. To enter the security system into the Valet mode.
2. Perform an emergency override in conjunction with the vehicle's ignition key in the case that your remote control is lost or inoperable.
3. To enter information in the programming procedure.

The Easy Valet switch should be mounted in a hidden location which is still accessible to you. Please become familiar with the location of the Easy Valet switch.

Valet Mode: In the Valet mode all of the system's security features have been turned "Off" and only the convenience features such as keyless entry and the auxiliary channels may be operated. Valet mode is designed for situations in which it is not convenient for the security portion of the system to be operational. For example: During extended stopovers for vehicle servicing, maintenance, valet parking, washing, etc.

To Enter "Valet" Mode: (With The System Disarmed)

Press & Hold the Easy Valet switch for 2 seconds.

-The siren will emit two chirps, the parking lights will flash twice, and the LED indicator will light solid Red to confirm that the alarm is in Valet.

Note: To remind the user that the system in the Valet mode, the siren will emit a chirp every time the vehicle's ignition is turned "Off".



To Exit "Valet" Mode:

Press & Release the Easy Valet switch.

-The LED indicator will turn "Off" to confirm exit from the Valet mode.

Emergency Override: In the event that your remote control is lost, damaged, or its batteries have become exhausted, the Easy Valet Switch & the vehicle's ignition key may be used to Disarm the system:

To Disarm The System Without Using A Remote Control:

- Step 1. With the system in the Armed condition, enter the vehicle via the driver's door (Be aware that the system will enter an alarm condition the instant the door is opened).
- Step 2. Using the ignition key, turn the vehicle's ignition to the "On" position.
- Step 3. Within 5 seconds, Enter the Override Valet Code by pressing & releasing the Easy Valet switch the programmed number of times (1-12). The system will Disarm 4 seconds later.



Note: Refer to programmable feature #2 on pg #24 for Valet Code programming instructions.

DUAL-STAGE IMPACT SENSOR TO MAXIMIZE SECURITY:

Sensors: This Crime Guard security system is equipped with a plug-in dual-stage InfraSonic & Glass Tampering Sensor to increase the effectiveness of the system.

The included sensor is just one in a comprehensive line of available sensors. Other available options are: impact sensors, pressure sensors, and microwave/radar sensors which can detect motion inside and outside the vehicle. Your Crime Guard dealer can provide details on the complete line of sensors and help determine which sensor or sensors are best suited for your needs.

- The system is factory programmed to automatically by-pass the sensor zone if it is triggered 5 times while the system is Armed. This feature can be overridden.
- The optional sensor may be temporarily by-passed using the remote control. (Refer to pg #13)

Prewarning Detection Circuit: When the sensor's prewarn zone is triggered the security system will respond by chirping the siren 3 times and relocking all of the doors (If installed). If the prewarn circuit is triggered 5 times while the system is Armed, the circuit will automatically shutdown until the security system is Disarmed and Rearmed again. This will prevent the security system from being a nuisance to the general public.

BACK-UP BATTERY:

This security system is equipped with a back-up battery inside the control module of the security system. The back-up battery will provide alternative power to operate the system if the vehicle's battery is disconnected. A built-in protection circuit will Not allow the back-up battery to back feed voltage into the vehicle's electrical system, thus prolonging battery life.

While operating on the backup battery, the system will automatically cancel the flashing lights output, the LED, and any optional sensors in order to conserve power. The siren will continue to operate at its maximum sound output, all protected entry zones will continue to be monitored, and the Starter Interrupt will operate at all times.

The back-up battery should be replaced by your authorized Crime Guard dealer every 18 months or anytime the back-up battery has operated the system on its own.

Anticipated life for the back-up battery under following conditions:

1. 2 days as the system's only power source while Armed.
2. 25 triggered cycles: A trigger cycle has a 60 second duration during which the siren is sounding. The cycle ends when the system automatically resets to the armed state.
3. 50 separate remote control Arm/Disarm commands.
4. 18 months if the 9 volt battery circuit has not been activated.

EXPLANATION OF PROGRAMMABLE FEATURES:

This Crime Guard security system is equipped with a remote control learning mode and 20 programmable features which allow the system to be customized to each application in order to better fit your needs.

• = Default Factory Setting

1. Transmitter Learning Mode: (4 Remotes Maximum)

-Allows the programming of remote controls to operate the system.

2. Programmable Override Valet Code: (• 1 Press Override)

-Allows programming of personal emergency override valet code.

This personal code can be used, in conjunction with the vehicle's ignition key, to Disarm the system in the event that a remote control is lost or inoperable and to disengage the anti car-jacking process once it has been triggered.

3. Chirp Confirmation: (•On/Off)

-Allows the permanent activation/deactivation of the systems siren chirp confirmation when performing functions (i.e.: Arm/Disarm chirp confirmations).

4. Alarm Condition Cycle Duration: (•30/60 Seconds)

-Allows the option of a 30 or 60 second alarm condition cycle.

5. Automatic Sensor Zone By-Pass: (•On/Off)

-Allows the system to automatically by-pass the sensor zone if the sensor is triggered 5 times while the system is Armed. The by-passed sensor would be reinstated the next time the system Arms.

6. Auxiliary Channel #1 Disarms System: (•On/Off)

-Allows auxiliary channel #1 to automatically Disarm the system when it is activated.

7. Automatic "Last Door" Arming: (•On/Off)

-Allows the system to automatically Arm itself 30 seconds after the vehicle's ignition is turned "Off" and the last door is closed.

• = Default Factory Setting

8. Doors Lock With "Last Door" Arming: (On/•Off)

-Allows the system to lock the vehicle doors when it automatically Arms itself 30 seconds after the vehicle's ignition is turned "Off" and the last door is closed.

9. Parking-Light Illumination Upon Disarm: (On/•Off)

-Allows the system to illuminate the vehicle's parking lights for 30 seconds upon Disarm.

10. Starter Interrupt Operates In Valet Mode: (On/•Off)

-Allows the system to engage the starter interrupt (If installed) when the remote transmitter is used to lock the vehicle doors while the system is in the Valet mode.

11. Door Lock/Unlock Pulse Duration: (•.8/3 Seconds)

-Allows the selection of a .8 second or a 3 second door lock/unlock pulse duration.

12. Ignition Activated Anti Car-Jacking: (On/•Off)

-Refer to pg #14.

13. Door Activated Anti Car-Jacking: (On/•Off)

-Refer to pg #14.

14. Remote Control Activated Anti Car-Jacking: (On/•Off)

-Refer to pg #14.

15. Automatic Rearm: (•On/Off)

-Allows the system to automatically Rearm 90 seconds after the system is Disarmed using a remote control. (Refer to pg #7)

16. Doors Lock With Automatic Rearm: (•On/Off)

-Allows the system to lock the vehicle doors when it automatically Rearms itself 90 seconds after the system is Disarmed using a remote control.

• = Default Factory Setting

17. Zone Activation Delay Upon Arming: (•3/45 Seconds)

-Allows the option of having the system's trigger zones become active 3 or 45 seconds after Arming. Affects both "last door" & remote Arming.

18. Doors Lock When Ignition Is Turned "On": (•On/Off)

-Allows the system to lock the vehicle doors when the ignition is turned "On".

19. Doors Unlock When Ignition Is Turned "Off": (•On/Off)

-Allows the system to unlock the vehicle doors when the ignition is turned "Off".

20. Unlock #2 When Ignition Is Turned "Off": (•On/Off)

-Allows the system to unlock the rest of the vehicle's doors if the driver's door unlock feature is selected, when the ignition is turned "Off".

21. Open Door Bypass W/ Ignition Door Locking: (•On/Off)

-Allows the system to cancel the door lock command when the vehicle's ignition is turned "On" if it detects an open door.

PROGRAMMING THE 328i²:

Up to 4 different remote controls and 20 features may be programmed into the security system's memory through the programming mode. To enter the programming mode follow the three steps listed below. Once in programming mode, Press & Release the Easy Valet switch the number of times equal to the number of the feature to be programmed. The siren will emit a number of chirps equal to the number of the feature to confirm that the desired feature has been selected.

Once selected, the feature's setting can be chosen by Pressing the appropriate button on the remote control. It is possible to "toggle" the feature's setting back and forth until either a different feature is selected or programming mode is exited. Features can be selected in any order, but it is always necessary to enter the feature's number into the Easy Valet switch by Pressing the Easy Valet switch the number of times equal to the number of the feature. (Refer to pages #20-22 for explanation of features)

For Example: If the user desires to program feature #15 then feature #3:

- a) First enter the programming mode.
- b) To access feature #15 (Automatic Rearm On/Off), Press the Easy Valet Switch 15 times. The siren will emit 15 chirps to confirm selection.
- c) Next, Press the appropriate remote control button to choose feature #15's setting. The siren will chirp to confirm.
- d) To access feature #3 (Chirp Confirmation On/Off), Press the Easy Valet Switch 3 times. The siren will emit 3 chirps to confirm selection.
- e) Press the appropriate remote control button to choose the feature #3's setting. The siren will chirp to confirm.
- f) Follow the same procedure to select any other feature for programming.
- g) Exit programming mode when finished.

To Enter Programing Mode:

Step 1: Turn the vehicles's ignition "On".

Step 2: Turn the vehicle's ignition "Off".

Step 3: Press & Release the Easy Valet switch 5 times.

-The siren will chirp to confirm entry into the programming mode.

To Exit Programing Mode: Turn the vehicles's ignition "On".

- The siren will chirp to confirm exit from programming mode.

Important Note: If at any time 10 seconds elapse without programming input, the system will automatically exit programming mode. The siren will chirp to confirm exit from the programming mode.

• = Default Factory Setting

1 Transmitter Learning Mode

Programming A Remote Control To Operate the Primary Vehicle:

Press & Release the Large button on each remote control to be programmed. All of the remote's channels will be learned.

Programming A Remote Control To Operate A 2nd Or 3rd Vehicle:

Up to three systems may be independently operated using a single remote control. The remote's button functions are different for each vehicle. This prevents Arming & Disarming the multiple systems simultaneously. (Refer to the following chart for button function assignment)

<u>Arm/Disarm</u>	<u>Aux Channel #1</u>	<u>Aux Channel #2</u>
Large Button	Small Button	Small Button
Small Button	Large Button	Small Button
Small Button	Large Button	Small Button

To program: Press & Release either of the small buttons on each remote control to be programmed. The system will automatically learn all of the remote's channels in a different order.

Important: When a new remote control is programmed into the system, all previous remotes in memory will be automatically deleted. If a third or fourth remote control is desired, all of the remotes must be programmed into system's memory.

2) Programmable Override Valet Code: (• 1 Press)

To enter a new valet override code: (1-12 Presses: 12 Maximum)

- Press & Release the Large button on the remote control.
 - The siren will chirp once to confirm system is ready to accept new code.
- Press & Release the Easy Valet switch 1-12 times before 5 seconds elapse. This number will be the new override code.
 - The siren will chirp 1-12 times to confirm the number entered.

Note: If no additional features need to be programmed, exit programming mode by allowing the 10 second time limit to expire without input. Do Not exit programming mode by turning "On" the ignition.

3) Chirp Confirmation: (●On/Off)

Chirps “On” = Press & Release Large Button. (Siren chirps once)

Chirps “Off” = Press & Release Small Button. (Siren chirps twice)

4) Alarm Condition Cycle Duration: (●30/60 Seconds)

30 Seconds = Press & Release Large Button. (Siren chirps once)

60 Seconds = Press & Release Small Button. (Siren chirps twice)

5) Automatic Sensor Zone By-Pass: (●On/Off)

By-Pass On = Press & Release Large Button. (Siren chirps once)

By-Pass Off = Press & Release Small Button. (Siren chirps twice)

6) Auxiliary Channel #1 Disarms System: (●On/Off)

Aux with Disarm = Press & Release Large Button. (Siren chirps once)

Aux No Disarm = Press & Release Small Button. (Siren chirps twice)

7) Automatic “Last Door” Arming: (●On/Off)

Arming On = Press & Release Large Button. (Siren chirps once)

Arming Off = Press & Release Small Button. (Siren chirps twice)

8) Doors Lock With “Last Door” Arming: (On/●Off)

Lock On = Press & Release Large Button. (Siren chirps once)

Lock Off = Press & Release Small Button. (Siren chirps twice)

9) Parking-Light Illumination Upon Disarm: (On/●Off)

Illumination On = Press & Release Large Button. (Siren chirps once)

Illumination Off = Press & Release Small Button. (Siren chirps twice)

10) Starter Interrupt Operates In Valet: (On/●Off)

Interrupt On = Press & Release Large Button. (Siren chirps once)

Interrupt Off = Press & Release Small Button. (Siren chirps twice)

11) Door Lock/Unlock Pulse Duration: (●.8/3 Seconds)

.8 Second = Press & Release Large Button. (Siren chirps once)

3 Seconds = Press & Release Small Button. (Siren chirps twice)

12) Ignition Activated Anti Car-Jacking: (On/●Off)

Car-Jacking On = Press & Release Large Button. (Siren chirps once)

Car-Jacking Off = Press & Release Small Button. (Siren chirps twice)

13) Door Activated Anti Car-Jacking: (On/•Off)

Car-Jacking On = Press & Release Large Button. (Siren chirps once)

Car-Jacking Off = Press & Release Small Button. (Siren chirps twice)

14) Remote Activated Anti Car-Jacking: (On/•Off)

Car-Jacking On = Press & Release Large Button. (Siren chirps once)

Car-Jacking Off = Press & Release Small Button. (Siren chirps twice)

15) Automatic Rearm: (•On/Off)

Rearm On = Press & Release Large Button. (Siren chirps once)

Rearm Off = Press & Release Small Button. (Siren chirps twice)

16) Doors Lock With Automatic Rearm: (•On/Off)

Lock On = Press & Release Large Button. (Siren chirps once)

Lock Off = Press & Release Small Button. (Siren chirps twice)

17) Zone Activation Delay Upon Arming: (•3/45 Sec)

3 Seconds = Press & Release Large Button. (Siren chirps once)

45 Seconds = Press & Release Small Button. (Siren chirps twice)

18) Doors Lock When Ignition Turned "On": (•On/Off)

Lock On = Press & Release Large Button. (Siren chirps once)

Lock Off = Press & Release Small Button. (Siren chirps twice)

19) Doors Unlock When Ignition Turned Off: (•On/Off)

Unlock On = Press & Release Large Button. (Siren chirps once)

Unlock Off = Press & Release Small Button. (Siren chirps twice)

20) Unlock #2 When Ignition Turned Off: (•On/Off)

Unlock On = Press & Release Large Button. (Siren chirps once)

Unlock Off = Press & Release Small Button. (Siren chirps twice)

21) Open Door Bypass w/Ignition Lock: (•On/Off)

Bypass On = Press & Release Large Button. (Siren chirps once)

Bypass Off = Press & Release Small Button. (Siren chirps twice)

• = Default Factory Setting

REMOTE TRANSMITTER REFERENCE GUIDE:

ARMING/DISARMING THE SYSTEM



THE SIREN WILL EMIT
CONFIRMATION CHIRP(S)



THE PARKING-LIGHTS
WILL FLASH

THE DOORS WILL LOCK/UNLOCK
(IF INSTALLED)

Press & Release The Large Button.

SILENTLY ARMING/DISARMING THE SYSTEM



1.



2.



THE PARKING-LIGHTS
WILL FLASH

THE DOORS WILL LOCK/UNLOCK
(IF INSTALLED)

First Press & Release The Lower Small Button, Then Press & Release The Large Button.

DISARM WITH DRIVER'S DOOR UNLOCK

STANDARD DISARM



1.

THE SIREN WILL EMIT CONFIRMATION CHIRP(S)
(NO CHIRPS IF SILENTLY DISARMED)



THE PARKING-LIGHTS
WILL FLASH

THE DRIVER'S DOOR WILL UNLOCK
(IF INSTALLED)

SILENT DISARM

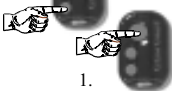

1.

To Unlock The Rest Of The Vehicle's Doors:

Within 3 Seconds Of Disarming The System, Press & Release The Large Button.



THE REST OF THE VEHICLE'S DOORS WILL UNLOCK
(IF INSTALLED)

PANIC



To Activate Panic: Press & Hold The Large Button for 3 Seconds.

To Deactivate Panic: Press & Release The Large Button.

AUXILARY CHANNEL #1

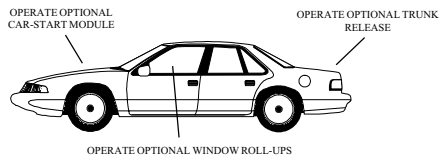

Press & Hold The Upper Small Button For 3 Seconds.

AUXILARY CHANNEL #2

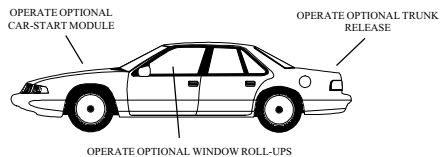

Press & Hold The Lower Small Button For 3 Seconds.

REMOTE ANTI CAR-JACKING



With the vehicle's ignition "On", Press & Hold The Lower Small Button For 3 Seconds.

-Remote anti car-jacking feature must be programmed for this feature to operate. (pg #14)

REMOTE SENSOR BY-PASS

STANDARD ARM



1.

SILENT ARM

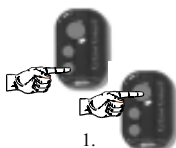

1.



2.

THE SIREN WILL CHIRP TO CONFIRM ARMING.
(NO CHIRPS IF SILENTLY ARMED):
THEN CHIRP TO CONFIRM SENSOR BY-PASS

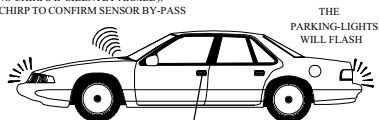

THE
PARKING-LIGHTS
WILL FLASH

THE DOORS WILL LOCK
(IF INSTALLED)

First Arm System, Then Within 4 Seconds Press & Release The Lower Small Button.

REMOTE TEMPORARY VALET

STANDARD DISARM



1.

SILENT DISARM

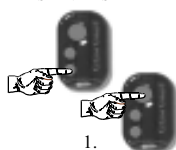

1.



2.

THE SIREN WILL CHIRP TO CONFIRM DISARM:
(NO CHIRPS IF SILENTLY DISARMED)



THE PARKING-LIGHTS WILL
FLASH TO CONFIRM DISARM:
THEN FLASH ONCE EVERY
2 SECONDS FOR 30 SECONDS

THE DOORS WILL UNLOCK
(IF INSTALLED)

First Disarm System, Then Within 4 Seconds Press & Release The Lower Small Button.

LIMITED LIFETIME WARRANTY

Products manufactured and sold by CRIME GUARD KEYLESS ENTRY & SECURITY (the "Company"), are warranted to be free from defects in materials and workmanship under normal use. If a product sold by the Company proves to be defective, the Company will repair or replace it free of charge within the first year and thereafter all parts to be repaired will be free with only a nominal charge for Crime Guard Keyless Entry & Security, Inc.'s labor and return shipping, to the original owner during the lifetime of the car in which it was originally installed.

All products for warranty repair must be sent postage prepaid to Crime Guard Keyless Entry & Security, Inc., P.O. Box 508, Douglasville, Georgia 30133, or send via UPS to: 981 N. Burnt Hickory Rd., Douglasville, Georgia 30134, with bill of sale or other dated proof of purchase. This warranty is nontransferable and does not apply to any product damaged by accident, physical or electrical misuse or abuse, improper installation, alteration, any use contrary to its intended function, unauthorized service, fire, flood, lightning, or other acts of God.

This warranty limits the Company's liability to the repair or replacement of the product. The Company shall not be responsible for removal and/or reinstallation charges, damage to or theft of the vehicle or its contents, or any incidental or consequential damages caused by any failure or alleged failure of the product to function properly. **UNDER NO CIRCUMSTANCES SHOULD THIS WARRANTY, OR THE PRODUCT COVERED BY IT, BE CONSTRUED AS A GUARANTEE OR INSURANCE POLICY AGAINST LOSS.** The Company neither assumes nor authorizes any person or organization to make any warranties or assume any liability in connection with the sale, installation, or use of this product.

This device complies with F.C.C Rules part 15. Operation is subject to the following two conditions: (1) This device may not cause harmful interference and, (2) This device must accept any interference that may be received, including interference that may cause undesired operation.

The manufacturer is not responsible for any radio TV interference caused by unauthorized modifications to this equipment. Such modifications could void the user's authority to operate the equipment.